

ESL-10

Extensive basic equipment of the machine

Compact design. The basic machine, electric control cabinet, cooling system, CNC control, control panel, and the workroom housing form a coherent unit on a very small area. Ergonomics, low center of gravity, operator-friendly and environmentally-friendly conditions, as well as the highest precision, and durability were taken into account when designing the unit.

The machine bed has a strong rib structure. Diagonal reinforcing ribs prevent vibrations during the machining process and thermal deformations. The results include high rigidity and the best vibration damping properties.

X and Z axes have been equipped with perfectly sized, hardened and polished linear roller guides (made in Japan).

Ball screws (made in Japan) are installed in all axes.

The spindle has best-in-class bearings (made in Japan), and it has been designed to absorb forces radially and axially.

FANUC 0i-TF control with an 8-inch LCD screen.

CE conformity



Specification

Item		Unit	Specifications	
			Type A	Type B
Capacity	Max. turning diameter	mm	φ180	
	Max. turning length	mm	190	
	Max. bar diameter	mm	(solid)	φ35 (hollow type, max. bar length: 1.2 m)
	Chuck size	inch	6	
Spindle	Spindle nose	JIS	A ₂ -5	
	Hole through spindle	mm	φ46	
	Spindle bearing I.D.	mm	φ75	
	Max. rotating speed	min ⁻¹	Max. 4,500	
	Spindle motor	kW	AC5.5/3.7	
Tool post	Type	Station	8	
	Max. tool size	mm	20 sq.	
	Max. boring bar diameter	mm	φ25	
Slide	Max. stroke	mm	X: 120	Z: 230
	Rapid traverse rate	m/min	X: 12	Z: 18
	Feed motor	kW	X: AC 0.75	Z: AC 1.2
Size	L × W × H	mm	1,450 × 1,295 × 1,650	
	Center height	mm	960	
	Machine weight	kg	1,670	
Motors	Coolant pump motor	kW	AC 0.25	
	Hydraulic pump motor	kW	AC 0.75	
	Turret drive motor	kW	AC 0.5	
Total power capacity		KVA	13	
Noise level		dB (A)	69	
Controller			TAKAMAZ FANUC 0i-TF	

Floor Space

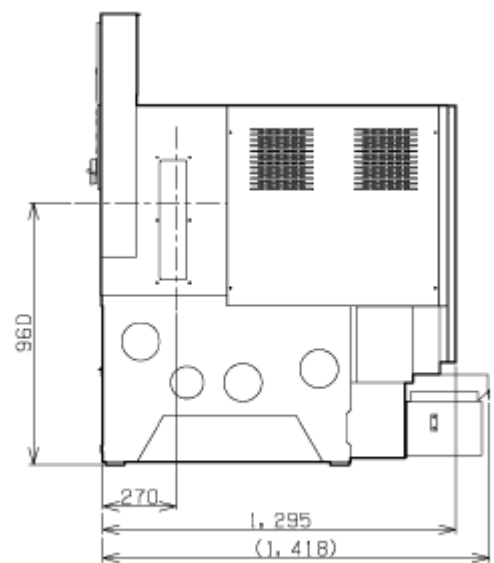
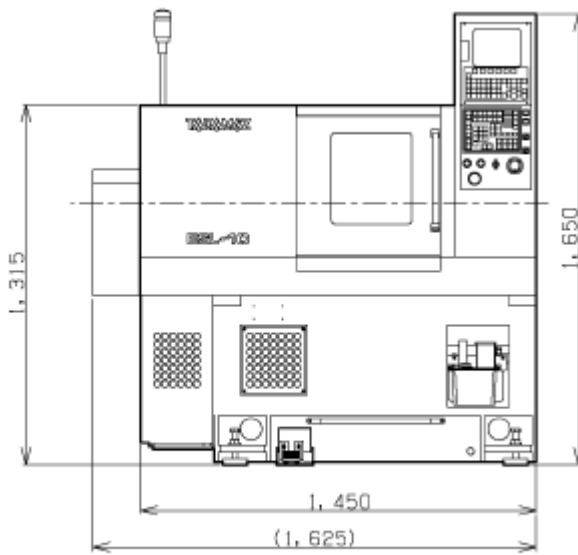
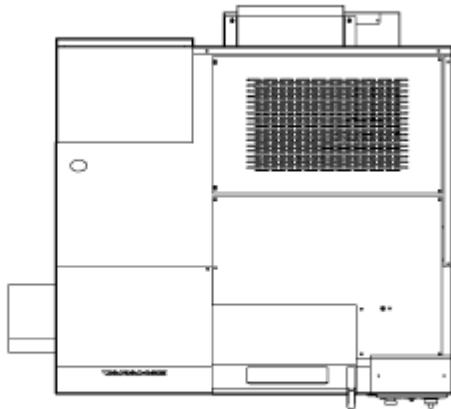

Spindle Motor Characteristic curve

5.5/3.7 kW (Max. 4,500 min⁻¹)

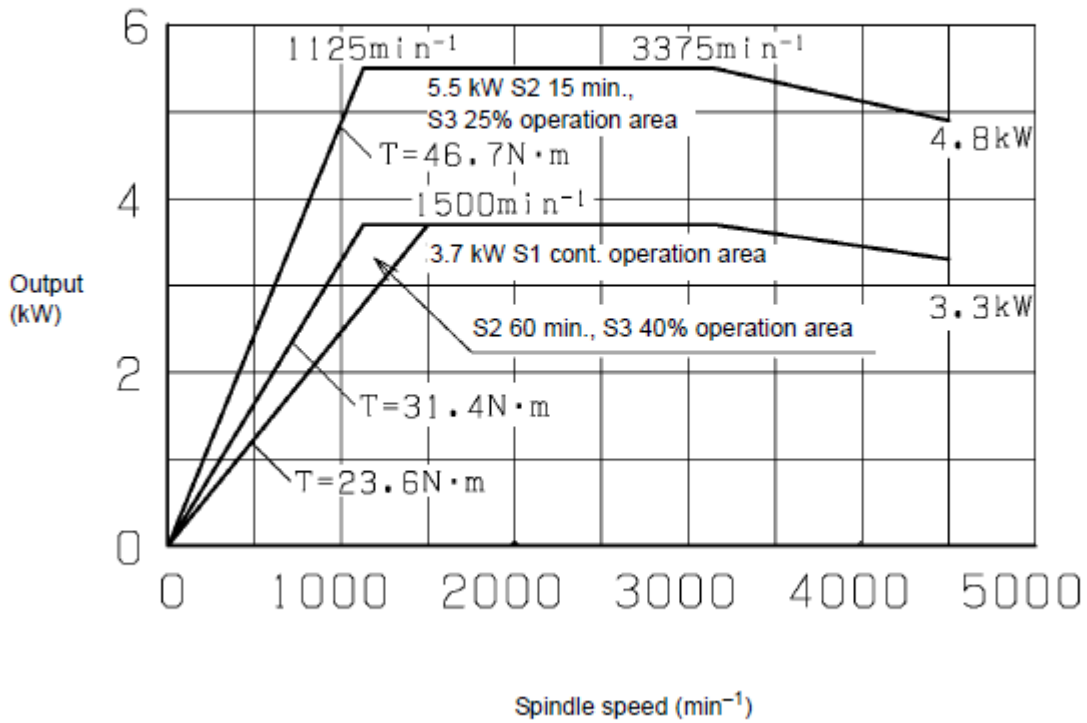

Spindle nose drawing

JIS A₂-5
 Type B, hollow type
 Chucking cylinder: VNK70-37 (SMW)

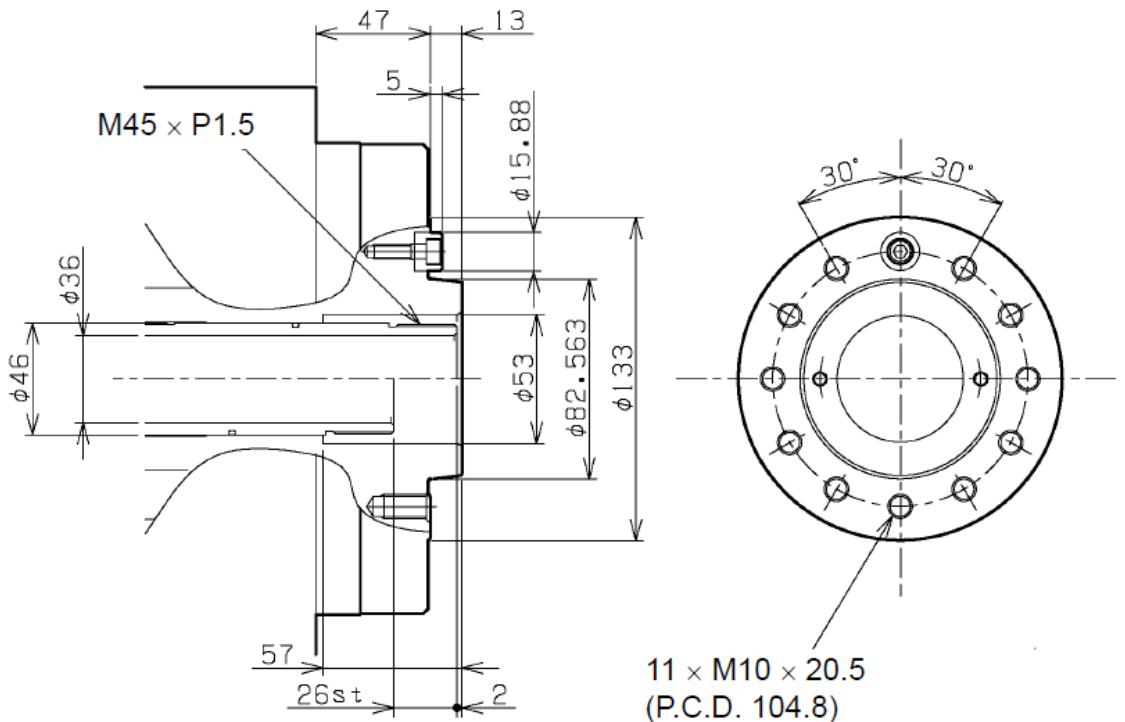

Stroke diagram

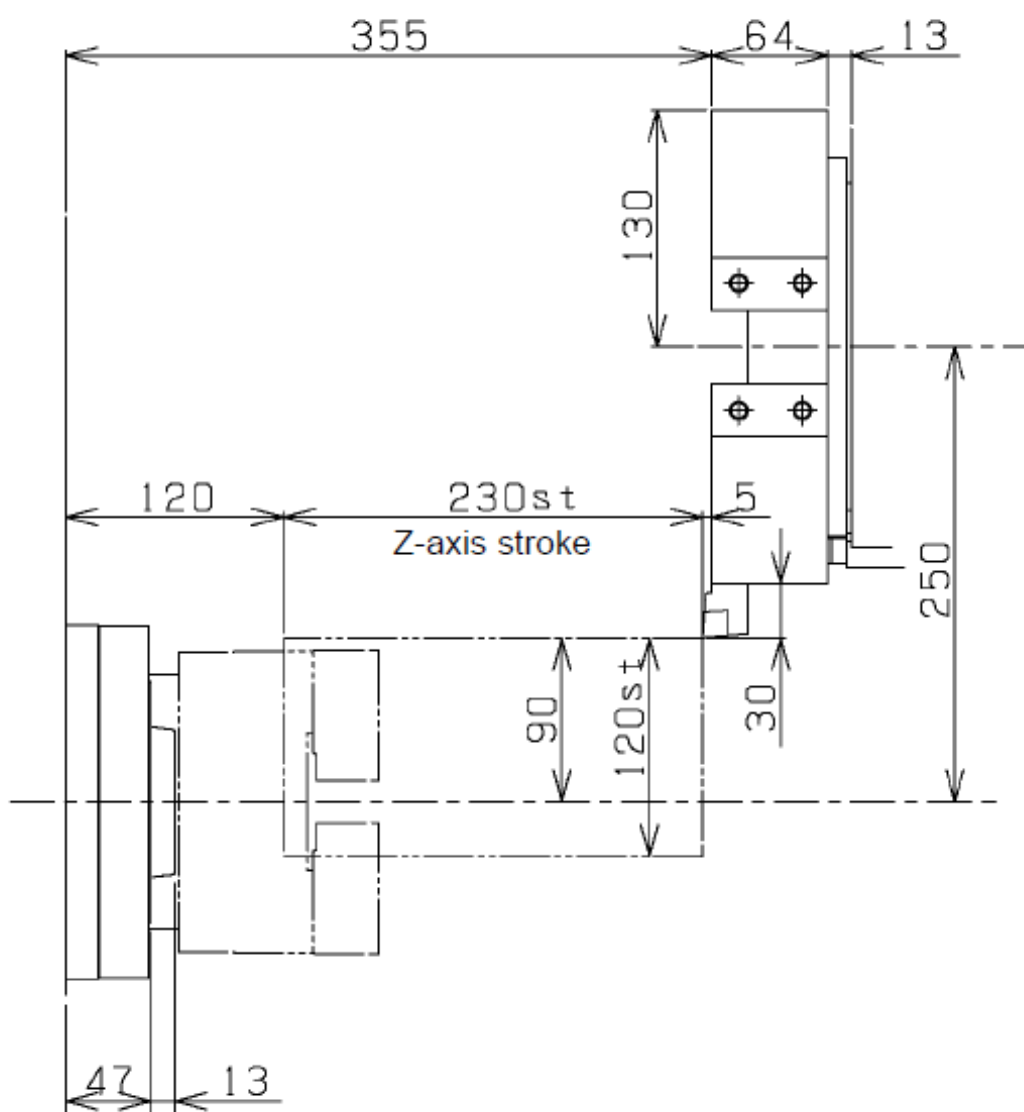

Tooling system

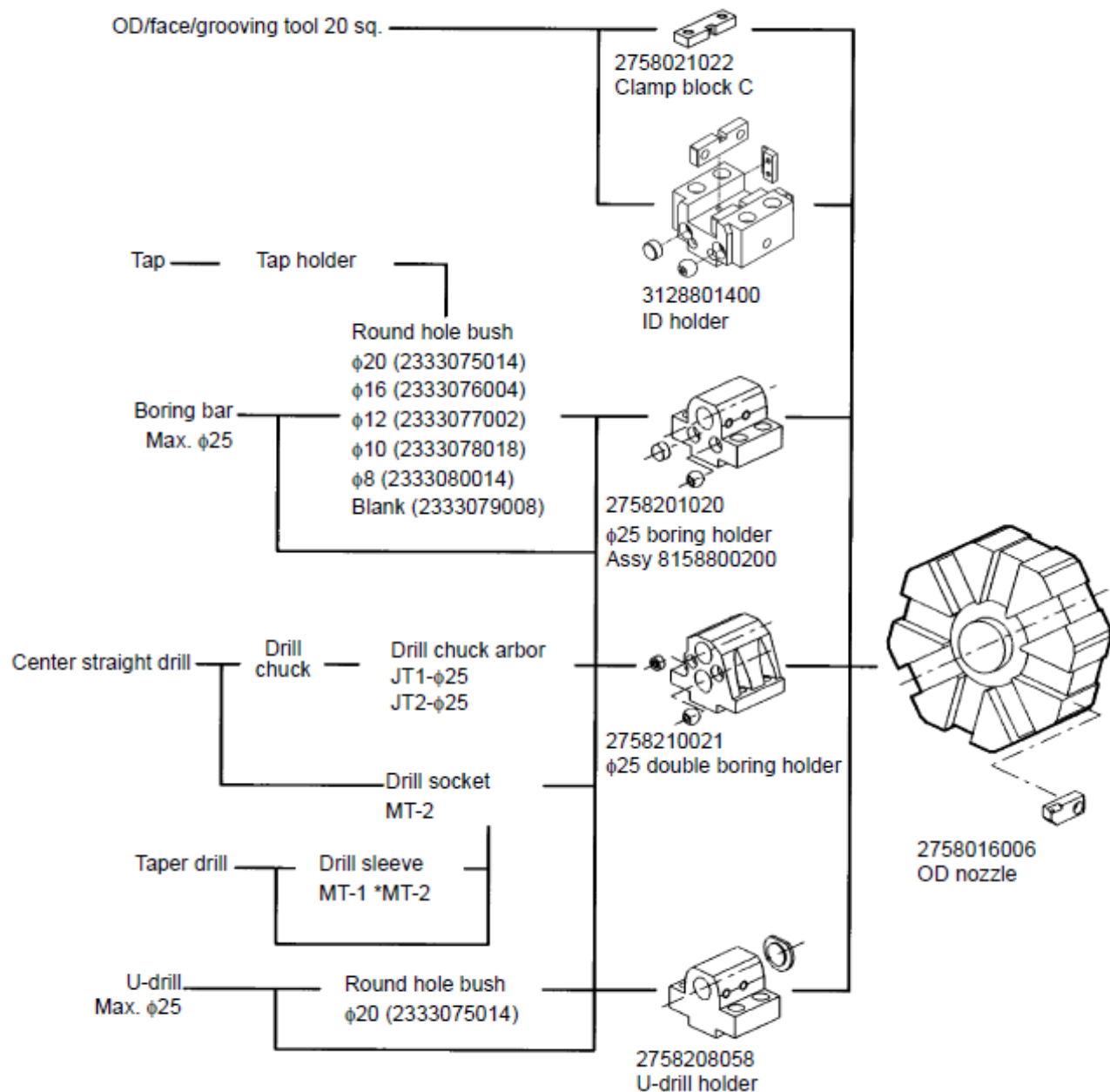

Do not use an ID holder (2758204024) provided for X-100 (X-10i or X-10). This holder will interfere with the cover when the turret turns.